

USER'S MANUAL
BEDIENUNGSANLEITUNG
MANUEL D'UTILISATION
MANUAL DE USUARIO
INSTRUKCJA OBSŁUGI
MANUALE D' USO



ROOT BAR BATTERY RGBW

CLROOTBARBAT

CONTENTS / INHALTSVERZEICHNIS / CONTENU / CONTENIDO / TREŚĆ / CONTENUTO

ENGLISH

INFORMATION ON THIS USER MANUAL	6
INTENDED USE	6
EXPLANATION OF TERMS AND SYMBOLS	6
SAFETY INSTRUCTIONS	7
CHARGING, USING, AND STORING BATTERIES	12
NOTES FOR PORTABLE INDOOR DEVICES	12
PACKAGING CONTENT	13
INTRODUCTION	13
CONNECTIONS, OPERATING AND DISPLAY ELEMENTS	14
OPERATION	16
IR REMOTE CONTROL	26
SET-UP AND INSTALLATION	28
INSTALLING THE FROST FILTER	32
MOUNTING THE GLARE SHIELD	32
MOUNTING THE NEON TUBE FILTER	33
CARE, MAINTENANCE, AND REPAIR	34
OPTIONAL ACCESSORIES	35
TECHNICAL DATA	36
MINIMUM DISTANCE TO ILLUMINATED SURFACE	37
MINIMUM DISTANCE TO NORMALLY FLAMMABLE MATERIALS	37
DISPOSAL	38
MANUFACTURER'S DECLARATIONS	39

DEUTSCH

INFORMATIONEN ZU DIESER BEDIENUNGSANLEITUNG	40
BESTIMMUNGSGEMÄSSER GEBRAUCH	40
BEGRIFFS- UND SYMBOLERKLÄRUNGEN	40
SICHERHEITSHINWEISE	41
AKKUS LADEN, BETREIBEN UND LAGERN	46
HINWEISE FÜR ORTSVERÄNDERLICHE INDOOR-GERÄTE	46
LIEFERUMFANG	47
EINFÜHRUNG	47
ANSCHLÜSSE, BEDIEN- UND ANZEIGEELEMENTE	48
BEDIENUNG	50
IR FERNBEDIENUNG	60
AUFSTELLUNG UND MONTAGE	62

FROSTFILTER MONTIEREN	66
BLENDSCHUTZ MONTIEREN	67
NEON-TUBE-FILTER MONTIEREN	67
PFLEGE, WARTUNG UND REPARATUR	68
OPTIONALES ZUBEHÖR	69
TECHNISCHE DATEN	70
MINDESTABSTAND ZUR BELEUCHTETEN FLÄCHE	71
MINDESTABSTAND ZU NORMAL ENTFLAMMBAREN MATERIALIEN	71
ENTSORGUNG	72
HERSTELLERERKLÄRUNGEN	73

FRANÇAIS

INFORMATIONS SUR CE MANUEL D'UTILISATION	74
UTILISATION PRÉVUE	74
EXPLICATION DES TERMES ET PICTOGRAMMES	74
CONSIGNES DE SÉCURITÉ	75
CHARGE, UTILISATION ET STOCKAGE DES BATTERIES	80
NOTES À PROPOS DES APPAREILS PORTABLES D'INTÉRIEUR	81
CONTENU DU CARTON	81
INTRODUCTION	81
CONNECTEURS, CONTRÔLES ET INDICATEURS	82
UTILISATION	84
CONTRÔLE PAR TÉLÉCOMMANDE INFRAROUGE	94
MONTAGE ET INSTALLATION	96
INSTALLATION DU FILTRE FROST	100
MONTAGE DE L'ÉCRAN ANTI-ÉBLOUISSEMENT	101
MONTAGE DU FILTRE TUBE NÉON	101
ENTRETIEN, MAINTENANCE ET RÉPARATION	102
ACCESSOIRES EN OPTION	103
CARACTÉRISTIQUES TECHNIQUES	104
DISTANCE MINIMALE PAR RAPPORT À LA SURFACE ÉCLAIRÉE	105
DISTANCE MINIMALE PAR RAPPORT AUX MATÉRIAUX INFLAMMABLES ORDINAIRES	105
MISE AU REBUT	106
DÉCLARATIONS DU FABRICANT	107

ESPAÑOL

INFORMACIÓN SOBRE ESTE MANUAL DE USUARIO	108
USO PREVISTO	108
EXPLICACIONES DE TÉRMINOS Y SÍMBOLOS	108
INSTRUCCIONES DE SEGURIDAD	109
CARGA, USO Y ALMACENAMIENTO DE LAS BATERÍAS	114
NOTAS PARA EQUIPOS PORTÁTILES QUE SE INSTALAN EN INTERIORES	114
CONTENIDO DEL EMBALAJE	115
INTRODUCCIÓN	115
CONEXIONES, MANDOS E INDICADORES	116
FUNCIONAMIENTO	118
MANDO A DISTANCIA POR INFRARROJOS	128
INSTALACIÓN Y MONTAJE	130
INSTALACIÓN DEL FILTRO DIFUSOR	134
MONTAJE DE LA PANTALLA ANTIRREFLEJOS	134
MONTAJE DEL FILTRO TUBO DE NEÓN	135
CUIDADO, MANTENIMIENTO Y REPARACIÓN	136
ACCESORIOS OPCIONALES	137
CARACTERÍSTICAS TÉCNICAS	138
DISTANCIA MÍNIMA A LA SUPERFICIE ILUMINADA	139
DISTANCIA MÍNIMA A MATERIALES NORMALMENTE INFLAMABLES	139
RECICLAJE	140
DECLARACIÓN DEL FABRICANTE	141

POLSKI

INFORMACJE NA TEMAT NINIEJSZEJ INSTRUKCJI OBSŁUGI	142
PRZEZNACZENIE	142
OBJAŚNIENIA TERMINÓW I SYMBOLI	142
INSTRUKCJE BEZPIECZEŃSTWA	143
ŁADOWANIE, UŻYTKOWANIE I PRZECHOWYWANIE AKUMULATORÓW	148
UWAGI DOTYCZĄCE PRZENOŚNYCH URZĄDZEŃ WEWNĘTRZNYCH	148
ZAWARTOŚĆ OPAKOWANIA	149
WPROWADZENIE	149
PRZYŁĄCZA, ELEMENTY OBSŁUGI / WSKAŹNIKI	150
OBSŁUGA	152
ZDALNE STEROWANIE NA PODCZERWIEŃ	162
KONFIGURACJA I INSTALACJA	164

INSTALACJA FILTRA FROST	168
MONTAŻ OSŁONY PRZECIWODBLASKOWEJ	169
MONTAŻ FILTRA NEONOWEGO NEON TUBE	169
PIELĘGNACJA, KONSERWACJA I NAPRAWA	170
AKCESORIA OPCJONALNE	171
DANE TECHNICZNE	172
MINIMALNA ODLEGŁOŚĆ OD OŚWIETLANEJ POWIERZCHNI	173
MINIMALNA ODLEGŁOŚĆ OD NORMALNIE ŁATWOPALNYCH MATERIAŁÓW	173
UTYLIZACJA	174
DEKLARACJE PRODUCENTA	175

ITALIANO

INFORMAZIONI SU QUESTO MANUALE DI ISTRUZIONI	176
USO PREVISTO	176
SPIEGAZIONI DI TERMINI E SIMBOLI	176
ISTRUZIONI DI SICUREZZA	177
CARICA, UTILIZZO E CONSERVAZIONE DELLE BATTERIE	182
NOTE SUI DISPOSITIVI MOBILI PER INTERNI	182
CONTENUTO DELL'IMBALLAGGIO	183
INTRODUZIONE	183
CONNESSIONI, ELEMENTI DI COMANDO E DI VISUALIZZAZIONE	184
FUNZIONAMENTO	186
TELECOMANDO IR	196
INSTALLAZIONE E MONTAGGIO	198
MONTAGGIO DEL FILTRO FROST	202
MONTAGGIO DELLA SCHERMATURA ANTIABBAGLIAMENTO	202
MONTAGGIO DEL FILTRO PER TUBO AL NEON	203
CURA, MANUTENZIONE E RIPARAZIONE	204
ACCESSORI OPZIONALI	205
DATI TECNICI	206
DISTANZA MINIMA DALLA SUPERFICIE ILLUMINATA	207
DISTANZA MINIMA DA MATERIALI NORMALMENTE INFIAMMABILI	207
SMALTIMENTO	208
DICHIARAZIONI DEL PRODUTTORE	209

DMX CONTROL / DMX STEUERUNG / PILOTAGE DMX / CONTROL DMX / STEROWANIE DMX / CONTROLLO DMX	210
---	-----

ENGLISH

You have made the right choice!

This device has been developed and manufactured to the highest quality standards to ensure many years of trouble-free operation. Please read this user manual carefully to be able to quickly put your new Cameo Light product to optimum use. Further information about Cameo Light is available on our website: **CAMEOLIGHT.COM**

INFORMATION ON THIS USER MANUAL

- Carefully read the safety instructions and the entire manual before operating the device.
- Observe the warnings on the device and in the user manual.
- Always keep the user manual within reach.
- If you sell or pass on the device, it is important that you also include this user manual, as it is an integral part of the product.

INTENDED USE

This product is a device for event technology!

This product has been developed for professional use in the field of event technology and is not suitable for use as domestic lighting!

Temporary operation! Event equipment is generally designed for temporary use only and not for continuous operation and fixed installation!

Furthermore, this product is only intended for qualified users with specialist knowledge of event technology!

Use of the product outside the specified technical data and operating conditions is considered improper use!

Liability is exempted when damage and third-party damage to persons and property is caused by inappropriate use!

The product is not suitable for:

- Persons (including children) with limited physical, sensory, or mental abilities or lack of experience and knowledge.
- Children (children must be instructed not to play with the device).

EXPLANATION OF TERMS AND SYMBOLS

1. **DANGER:** The word DANGER, possibly in combination with a symbol, indicates immediately hazardous situations or conditions for life and limb.
2. **WARNING:** The word WARNING, possibly in combination with a symbol, indicates potentially hazardous situations or conditions for life and limb.
3. **CAUTION:** The word CAUTION, possibly in combination with a symbol, indicates situations or conditions that may lead to injury.
4. **ATTENTION:** The word ATTENTION, possibly in combination with a symbol, indicates situations or conditions that may lead to damage to property and/or the environment.



This symbol identifies hazards that can cause electric shock.



This symbol indicates hazardous areas or hazardous situations.



This symbol indicates hazards caused by hot surfaces.



This symbol indicates that you must avoid looking or staring at the light source.



This symbol indicates hazards due to suspended loads.



This symbol indicates a device in which there are no user-serviceable parts.



This symbol indicates additional information on the operation of the product.



This symbol indicates a device that may only be used in dry rooms.

SAFETY INSTRUCTIONS



DANGER:

1. Do not open the device, and do not make any modifications to it.
2. If your device no longer functions properly, if liquids or objects get inside it, or if it has been damaged in any other way, switch it off immediately and disconnect it from the power supply. The device may be repaired only by authorised qualified personnel.
3. For devices of protection class 1, the protective conductor must be connected correctly. Never disconnect the protective conductor. Devices of protection class 2 do not have a protective conductor.
4. Ensure that live cables are not kinked or otherwise mechanically damaged.
5. Never bypass the device fuse.



WARNING:

1. The device may not be operated if it shows obvious signs of damage.
2. The device may only be installed in a voltage-free state.
3. If the device's mains cable is damaged, the device may not be operated.
4. Permanently attached mains cables may only be replaced by a qualified person.

**ATTENTION:**

1. Do not operate the device if it has been exposed to large temperature fluctuations (for example, after transport). Moisture and condensation may damage the device. Switch on the device only when it has reached ambient temperature.
2. Make sure that the voltage and frequency of the mains correspond to the values specified on the device. If the device has a voltage selector switch, do not connect the device until it has been set correctly. Use only suitable mains cables.
3. To disconnect the device from the mains at all poles, it is not sufficient to press the on/off switch on the device.
4. Make sure that the fuse used corresponds to the type specified on the device.
5. Make sure that appropriate measures have been taken against power surges (for example, lightning strike).
6. Observe the specified maximum output current on devices with Power Out connection. Ensure that the total current consumption of all connected devices does not exceed the specified value.
7. Replace plug-in mains cables only with original cables.
8. Connect the device only to compliant, tested, and undamaged power outlets.

**DANGER:**

1. Danger of suffocation/choking! Plastic bags and small parts must be kept out of reach of persons (including children) with reduced physical, sensory, or mental capabilities.
2. Danger caused by falling device! Make sure that the device is securely installed and cannot fall down. Only use suitable stands or mounts (particularly for fixed installations). Ensure that accessories are properly installed and secured. Ensure that applicable safety regulations are observed.

**WARNING:**

1. Use the device only in the prescribed manner.
2. Operate the device only with the accessories recommended and intended by the manufacturer.
3. During installation, observe the safety regulations applicable in your country.
4. After connecting the device, check all cable routes to avoid damage or accidents, for example, due to tripping hazards.
5. Always observe the specified minimum distance to normally flammable materials! Unless explicitly stated, the minimum distance is 0.3 m.

**CAUTION:**

1. Moving components such as mounting brackets or other movable components may become jammed.
2. Devices with motor-driven components may result in injury from the movement of the device. Sudden movement of the device can cause shock reactions.
3. The exterior surface of the device can become very hot during regular operation. Ensure that accidental touching of the housing is not possible. Always allow the device to cool sufficiently before removal, maintenance work, charging, or similar.

**ATTENTION:**

1. Do not install or operate the device near any radiators, heat registers, stoves, or other heat sources. Ensure that the device is always installed in such a way that it is sufficiently cooled and cannot overheat.
2. Do not place ignition sources such as burning candles near the device.
3. Ventilation openings must not be covered, and fans must not be blocked.
4. Use the original packaging or packaging provided by the manufacturer for transport.
5. Avoid shock or impact to the device.
6. Observe the IP protection class, as well as the ambient conditions such as temperature and humidity according to the specification.
7. Devices can be constantly further developed. In the event of deviating information on operating conditions, performance, or other device properties between the user manual and the device labelling, the information on the device always takes priority.
8. The device is not suitable for tropical climates and for operation above 2,000 m above sea level.
9. Unless explicitly stated, the device is not suitable for operation in marine conditions.

**PLEASE NOTE:**

For conversion or retrofit sets or accessories provided by the manufacturer, always follow the enclosed instructions.

**CAUTION! IMPORTANT NOTES ON LIGHTING PRODUCTS!**

This device is assigned to risk group 0.



1. Never look directly into the light source, not even for a short period of time.
2. Never look into the beam of light using optical devices such as a magnifying glass.
3. Stroboscopic effects may cause epileptic seizures in susceptible individuals!
4. Permanently installed lamps are built into these lighting units. These may not be replaced by the user. The lamps contained in this light source may only be replaced by the manufacturer, its service partner, or a similarly qualified person.





RADIO SIGNAL TRANSMISSION

(FOR EXAMPLE, W-DMX OR RADIO-BASED AUDIO SYSTEMS)

The quality and performance of wireless signal transmissions generally depend on the ambient conditions.

For example, the following factors can impact range and signal stability:

Shielding (for example, masonry, metal structures, water)

High volumes of radio traffic (for example, powerful wireless LAN networks)

Interference

Electromagnetic radiation (for example, LED video screens, dimmers)

All range specifications refer to free-field line-of-sight applications without interference!

The operation of radio transmission systems is subject to official regulations. These may vary from region to region and must be checked by the operator before use (for example, radio frequency and transmission power).



WARNING: Devices with wireless signal transmission are not suitable for use in sensitive areas in which radio operation can lead to potentially detrimental interactions. These include:

- Hospitals, health centres, or other healthcare facilities that provide patient treatment with qualified personnel and equipment.
- Class I, II, and III hazardous areas
- Restricted areas
- Military facilities
- Aircraft or vehicles
- Areas where the use of mobile phones is prohibited



WIRELESS DMX SIGNAL TRANSMISSION

WARNING: In general, wireless DMX transmission must not be used for applications involving safety-related factors that might result in personal injury or property damage in the event of a failure.

This applies in particular to moving scene or truss structures, DMX-controlled motors/lifts, or lifting devices for operating DMX-operated platform lifts, hydraulic systems, or comparable moving components.

Furthermore, wireless DMX transmission must not be used to control flame or pyrotechnic devices, explosion-driven effects, or gas or liquid effects. These include CO₂ cannons, confetti shooters, water effects, or similar.



BATTERY DEVICES AND CHARGERS

DANGER:

1. Keep the battery-powered device away from heat sources, and do not expose it to direct sunlight. Do not place it on or in heating appliances such as microwaves, ovens, or radiators. Batteries can explode if overheated. Always observe the care instructions and ensure the ambient conditions are appropriate! These are detailed in the technical specifications.
2. Do not open the device! Do not modify the battery, and do not attempt to replace the battery cells!
3. Battery cells or battery packs must not be damaged. Do not remove any protective film or stickers. Do not insert any foreign objects into the battery. Do not allow liquids to get into the battery. There is a risk of fire and explosion as well as other dangerous situations (for example, outgassing).
4. If the device becomes deformed or overheats, stop using it immediately! If you continue to operate the device, there is a danger of fire and explosion as well as a danger of other hazardous situations (for example, outgassing).
5. Do not throw the device into a fire! Danger of explosion!
6. Do not subject the device to strong mechanical effects! Damage caused by falling, crushing, or piercing, as well as high pressure, leads to a danger of fire and explosion as well as a danger of other hazardous situations (for example, outgassing).
7. Only charge the device or battery in the intended manner.
8. Please note that device's main switch does not deactivate the charging function on all devices.
9. In the case of charging devices built into transport cases, charging may only be carried out when the lid is open.
10. Leaked fluid is corrosive and can be toxic. It can cause skin and eye irritations and is dangerous if swallowed. Avoid any contact with leaked fluid. In the event of contact with leaked fluid, immediately wash the affected area with plenty of water and contact a doctor.



CHARGING, USING, AND STORING BATTERIES

1. To charge permanently installed batteries, connect the device to the correct power supply. Please note that the device's main switch does not deactivate the charging function on all devices.
2. The charging time for a full charge of the battery can be found in the technical data. For information on how to display the battery charge status, see chapter OPERATION.
3. Devices with lithium batteries are equipped with standard protective features.
4. Do not charge the battery outside the ambient conditions specified in the technical data. Unless otherwise specified, these are between +5° and +35° Celsius in dry environments.
5. The permissible ambient conditions for operation can be found in the technical data. Unless otherwise specified, these must not be below +5°C or above +35°C in dry environments.
6. The permissible ambient conditions for storage can be found in the technical data. Unless otherwise specified, these must not be below +5°C or above +35°C in dry environments.
7. Fully recharge the battery immediately after discharge.
8. Only store the device with a fully charged battery. Batteries that are not fully charged may lose capacity and service life prematurely.
9. If the device is not to be used for a longer period of time, perform a full discharge and charge cycle no later than every three months.
10. The device's main switch must be switched off during storage.
11. The specified battery operating times always refer to a new battery and normal operating conditions.
12. The battery operating time may be shorter than specified when operated in cold environments.
13. If the operating time of the device in battery operation deviates significantly from the specifications, please contact your distribution partner.



NOTES FOR PORTABLE INDOOR DEVICES

1. Temporary operation! Event equipment is generally only designed for temporary operation.
2. Continuous operation or permanent installation can impair the functionality of the device and cause premature ageing.

PACKAGING CONTENT

Remove the product from the packaging, and remove all packaging material.

Please check the completeness and integrity of the delivery, and notify your distribution partner immediately after purchase if the delivery is not complete or if it is damaged.

The packaging content for the product includes:

- ▶ 1 × ROOT BAR BAT RGBW
- ▶ 2× Omega mounting bracket
- ▶ 2× adjustable stand
- ▶ 1× glare shield
- ▶ 1× diffuser
- ▶ 1× neon tube filter
- ▶ 1× mains cable
- ▶ Safety and compliance information (user manual as a download via QR code)

INTRODUCTION

LED ROOT BAR BATTERY

CLROOTBARBAT

CONTROL FUNCTIONS:

2-channel, 4-channel sound, 4-channel 2, 5-channel, 6-channel direct, 6-channel pattern, 9-channel sound, 9-channel pattern, 16-channel, 19-channel, D3-channel, D5-channel sound, D5-channel direct, D6-channel, D7-channel, and D10-channel DMX control
DMX512

Wireless DMX via optionally available Cameo iDMX stick

Control via IR remote control (remote control optionally available)

Master/slave operation

Stand-alone functions

FEATURES:

Battery operation. 12× 4 W RGBW LEDs. DMX512. Connection for optional iDMX stick for wireless control via W-DMX. IR remote control optionally available. 3-pin DMX connections. Multi-angle installation thanks to tool-free folding feet. Two Omega mounting brackets and two adjustable feet included. Glare shield, diffuser, and neon tube filter included.

CONNECTIONS, OPERATING AND DISPLAY ELEMENTS

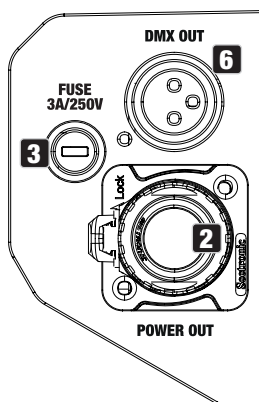
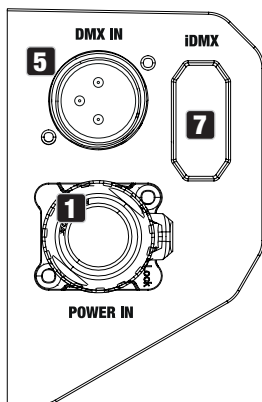
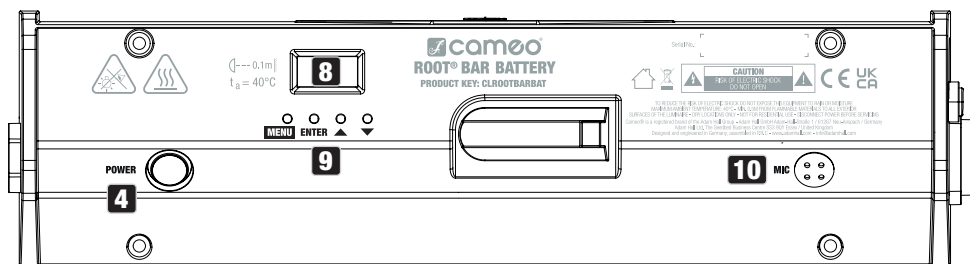

1 POWER IN

Power Twist mains input socket. Operating voltage 100–240 V AC / 50–60 Hz. Connect using the included mains cable.

2 POWER OUT

Power Twist mains output socket. Enables power supply to other CAMEO lights. Ensure that the total power consumption of all connected devices does not exceed the value specified on the device in amperes (A).

3 FUSE

Fuse holder for 5 × 20 mm fuses. **IMPORTANT NOTE:** Only replace the fuse with a fuse of the same type and value. In the event of repeated fuse failure, please contact an authorised service centre.

4 POWER

Push switch for switching the light on and off.

5 DMX IN

Male 3-pin XLR socket for connection to a DMX control device (for example, DMX console).

6 DMX OUT

Female 3-pin XLR socket for sending the DMX control signal.

7 iDMX

Connection for the optionally available iDMX stick for wireless DMX connection (insert the iDMX stick with the antenna facing the DMX IN socket).

8 OLED DISPLAY

The OLED display shows the currently active operating mode (main screen), the menu items, and the numerical value or operational status of certain menu items. If no input is made within approximately one minute, the display automatically returns to the main screen. Note on the main screen in operating modes with external control: In the event that the control signal is interrupted, the characters in the display begin flashing; once the control signal is present again, the flashing stops.

9 CONTROL BUTTONS

MENU – press MENU to access the main menu. Press again or repeatedly to return to the main screen. Pressing MENU without confirming a value or status change by pressing ENTER restores the previously confirmed value or status.

ENTER – press ENTER to access the menu and submenus. ENTER is also used to confirm value or status changes.

▲ and **▼** – select menu items in the main menu (DMX address, DMX mode, etc.) and in the sub-menus. Allows you to change the value of a menu item, such as the DMX address (long press = quick value change), as desired.

10 MIC

Microphone for music control in the stand-alone operating modes **Auto** and **Pattern** and the DMX operating modes with sound channel.

INFRARED SENSOR

The infrared sensor for control via IR remote control is found on the front of the fixture.

OPERATION

NOTES

- As soon as the fixture is switched on, the following are displayed in succession: "Welcome to Cameo", the model name, and the software version. After this process, the fixture is ready for operation, and the previously activated operating mode is launched.
- To return directly from the sub-menus to the main display, press and hold MENU for around two seconds.

The main display is activated automatically after approximately two minutes of no input. To navigate one level up in the sub-menus, briefly press MENU.

- To directly access the previously edited menu item, briefly press MENU and ENTER at the same time.
- Briefly pressing the ▲ button when in the main display rotates the display by 180°.
- To quickly change a value, such as the DMX start address, press and hold ▲ or ▼.

MAIN DISPLAY IN DMX OPERATING MODE

In DMX operating mode, the main display shows the currently set DMX start address (see illustration). When the DMX Delay feature is activated, the delay group and delay time are also displayed. Flashing characters in the display indicate that the fixture has no DMX signal.



MAIN DISPLAY STAND-ALONE OPERATING MODE

The display shows the currently activated stand-alone operating mode.



MAIN DISPLAY SLAVE MODE

The display shows slave mode. If the slave unit is assigned to a slave group, the slave group and the delay time set in the master unit under the stand-alone operating modes Auto, Pattern, and Loop are also displayed.



SETTING THE DMX START ADDRESS (DMX Address)

Starting from the main display, press MENU to enter the main menu. Now use ▲ or ▼ to select the menu item **DMX address** and confirm with ENTER. Now use the ▲ or ▼ buttons to config-

ure the desired DMX start address and press ENTER to confirm (highest value dependent upon activated DMX mode).

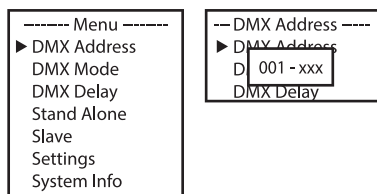

SETTING THE DMX OPERATING MODE (DMX Mode)

Starting from the main display, press MENU to enter the main menu. Now use ▲ or ▼ to select the menu item **DMX Mode** and confirm with ENTER. Select the desired DMX operating mode using ▲ or ▼ and confirm with ENTER. Tables with the channel assignment of the different DMX modes can be found in these instructions under DMX CONTROL.

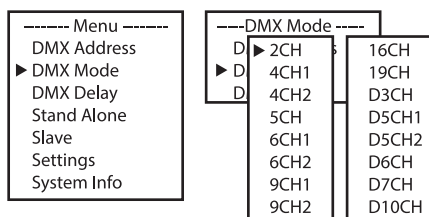

DMX DELAY

The DMX Delay function is a simple way to create a running light effect with a large number of fixtures that are all the same model and that are all running the same software version. This is otherwise only achievable with a suitable DMX controller and time-consuming programming. All the fixtures used in this are set to the same DMX operating mode and controlled via the same DMX start address. All DMX modes with the delay channel are labelled with D.

Assign the fixtures to one of up to 47 groups (plus group 0) as desired (maximum group number depends on the activated DMX operating mode). Multiple fixtures may be assigned to a group. The group number is also the factor by which the set delay time is multiplied (see set-up example).

Starting from the main display, press MENU to access the main menu. Use the ▲ and ▼ buttons to select the menu item **DMX Delay** and confirm by pressing ENTER twice. Now use ▲ and ▼ to set the group as required and confirm the entry with ENTER.

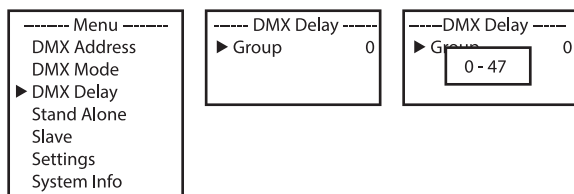

The delay time of the DMX signal is set by means of a DMX controller in the separate DMX delay channel of the corresponding DMX operating mode (0.0 s to 2.0 s in 0.1 s increments).

Set-up example:

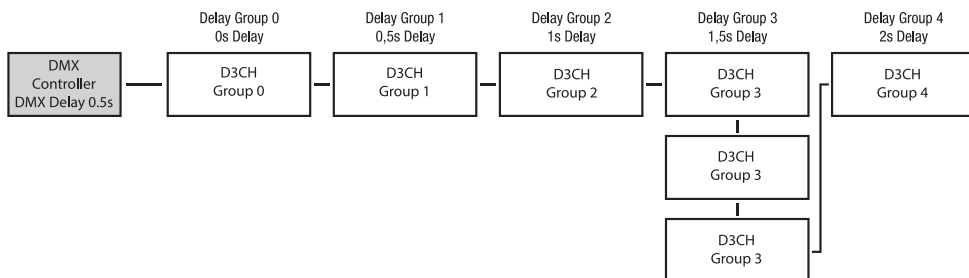

AUTO STAND-ALONE OPERATING MODE

The six available auto programs partly comprise hard-coded colour-change sequences. Brightness, running speed, music control, microphone sensitivity, and delay can be set separately for each program.

Starting from the main display, press MENU to access the main menu. Using the ▲ and ▼ buttons, now select the menu item **Stand Alone** and confirm with ENTER. Again use ▲ and ▼ to select the stand-alone operating mode **Auto** and confirm with ENTER. Now use ▲ and ▼ to select the desired program (program 1 to program 6) and confirm again with ENTER.

----- Menu ----- DMX Address DMX Mode DMX Delay ▶ Stand Alone Slave Settings System Info	----- Stand Alone ----- ▶ Auto Static Color Preset Pattern User Color Loop	----- Auto Mode ----- ▶ Program 1 Program 6	----- Program x ----- ▶ Dimmer 0 - 100 Speed 0 - 100 Sound Off / On Sens 0 - 100 Delay 0.0s - 2.0s
---	--	--	---

This takes you to the sub-menu for setting the sub-menu items (see table, select with ▲ and ▼, confirm with ENTER, change value or status with ▲ and ▼, and confirm with ENTER). The settings for each program are made separately and are retained even after restarting the device.

AUTO STAND-ALONE OPERATING MODE (Program 1 to Program 6)

Dimmer	Sets the brightness	0 - 100	
Speed	Sets the running speed	0 - 100	
Sound	Activates/deactivates music control	Off	Deactivates music control
		On	Activates music control

Sens	Sets microphone sensitivity	0 - 100	
Delay	Delay time for slave groups	0.0s - 2.0s	

STATIC STAND-ALONE OPERATING MODE

The static stand-alone operating mode allows the dimmer, strobe, and R, G, B, and W values to be set directly on the device with values in a similar way to a DMX controller. This allows you to create a custom scene without an additional DMX controller.

Starting from the main display, press MENU to access the main menu. Using ▲ and ▼, now select **Stand Alone**, confirm with ENTER, then select **Static**, and confirm once again with ENTER. Now select the menu item you want to edit, confirm the selection, set the desired value, and confirm the entry.

----- Menu ----- DMX Address DMX Mode DMX Delay ▶ Stand Alone Slave Settings System Info	----- Stand Alone ----- Auto ▶ Static Color Preset Pattern User Color Loop	----- Static Mode ---- ▶ Dimmer 0 - 255 Strobe 0 - 255 Red 0 - 255 Green 0 - 255 Blue 0 - 255 White 0 - 255
---	--	---

COLOUR PRESET STAND-ALONE OPERATING MODE

15 different colour presets plus a jump and a fade preset with adjustable running speed are available.

Starting from the main display, press MENU to enter the main menu. Using ▲ and ▼, select the menu item **Stand Alone**, confirm the selection, then select **Colour Preset**, and confirm again with ENTER. The desired preset can now be selected. Confirm the selection, set the brightness from 0 to 100, and confirm once again. The running speed (Speed) can also be set for the two presets Jump and Fade.

----- Menu ----- DMX Address DMX Mode DMX Delay ▶ Stand Alone Slave Settings System Info	----- Stand Alone ----- Auto Static ▶ Color Preset Pattern User Color Loop	----- Color Preset ---- Off ▶ Red 0 - 100 Amber 0 - 100 Yel Warm 0 - 100 Yellow 0 - 100 Green 0 - 100 Turquoise 0 - 100 Cyan 0 - 100 Blue 0 - 100 Lavender 0 - 100	----- Color Preset ---- Mauve 0 - 100 Magenta 0 - 100 Pink 0 - 100 Warm White 0 - 100 White 0 - 100 Cold White 0 - 100 Jump 0 - 100 Fade 0 - 100 Speed 0 - 100
---	--	--	---

PATTERN STAND-ALONE OPERATING MODE

The 12 available patterns each consist of pre-programmed four-segment patterns. Brightness, running speed, colour preset, music control, microphone sensitivity, and delay can be set separately for all patterns.

Starting from the main display, press MENU to access the main menu. Using the ▲ and ▼ buttons, now select the menu item **Stand Alone** and confirm with ENTER. Use ▲ and ▼ again to select the stand-alone operating mode **Pattern** and confirm with ENTER.

----- Menu -----
DMX Address
DMX Mode
DMX Delay
► Stand Alone
Slave
Settings
System Info

----- Stand Alone -----
Auto
Static
Color Preset
► Pattern
User Color
Loop

----- Pattern -----
► Dimmer 0 - 255
Strobe 0 - 255
Color Red...
Pattern 1 - 12
Speed 0 - 255
Sound Off / On
Sens 0 - 100
Delay 0.0s - 2.0s

This takes you to the sub-menu for setting the sub-menu items (see table, select with ▲ and ▼, confirm with ENTER, change value or status with ▲ and ▼, and confirm with ENTER).

PATTERN STAND-ALONE OPERATING (Pattern 1–Pattern 12)

Dimmer	Sets brightness	0 - 100	
Strobe	Multifunctional stroboscope (see, for example, DMX operating mode 6CH pattern, channel 2)	0 - 255	
Colour	Selects the colour presets	Red - CW / User 1 - 4	
Pattern	Selects the pattern	1 - 12	
Speed	Sets the running speed and running direction of the patterns (see, for example, DMX operating mode 6CH pattern, channel 5)	0 - 255	
Sound	Activates/deactivates music control	Off On	
Sens	Sets microphone sensitivity	0 - 100	
Delay	Delay time for slave groups	0.0s - 2.0s	

USER COLOUR STAND-ALONE OPERATING MODE

The four user presets available in the stand-alone operating mode User Colour can be edited individually. Starting from the main display, press MENU to access the main menu. Using ▲ and ▼, select the menu item **Stand Alone**, confirm with ENTER, then select **User Colour**, and confirm once again. Select the desired preset (Colour 1–Colour 4) and confirm the selection. Now select the menu item you want to edit, confirm the selection, set the desired value, and confirm the entry.

----- Menu -----
DMX Address
DMX Mode
DMX Delay
► Stand Alone
Slave
Settings
System Info

----- Stand Alone -----
Auto
Static
Color Preset
Pattern
► User Color
Loop

----- User Color -----
► Color 1
Color 4

----- Color x -----
► Dimmer 0 - 255
Strobe 0 - 255
Red 0 - 255
Green 0 - 255
Blue 0 - 255
White 0 - 255

LOOP STAND-ALONE OPERATING MODE

Brightness, step duration, and fade time can be set separately for all four loops. Starting from the main display, press MENU to access the main menu. Using UP and DOWN, select the menu item **Stand Alone**, confirm with ENTER, then select **Loop**, and confirm once again. Now select the desired loop for playback and editing and confirm the selection.

----- Menu -----
DMX Address
DMX Mode
DMX Delay
► Stand Alone
Slave
Settings
System Info

----- Stand Alone -----
Auto
Static
Color Preset
Pattern
User Color
► Loop

----- Loop Mode -----
► Loop 1
Loop 4

----- Loop x -----
► Dimmer 0 - 100
Step time 0.1s-10.0s
Fadetime 0%-100%
Delay 0.0s - 2.0s
1.Step Red...
2.Step Red...
3.Step Red...
4.Step Red...

This will take you to the sub-menu for setting the sub-menu items (see table). The settings for each loop are made independently and are retained even after restarting the device.

LOOP STAND-ALONE OPERATING MODE (Loop 1–Loop 4)		
Dimmer	Sets the brightness	0 - 100
Step time	Sets the step time	0.1s - 10.0s
Fadetime	Sets the fade time	0% - 100%
Delay	Delay time for slave groups	0.0s - 2.0s
1.Step	Select colour preset or blackout for step 1	Red - CW / User 1 - 4 / Blackout
2.Step	Select colour preset or blackout for step 2	Red - CW / User 1 - 4 / Blackout
3.Step	Select colour preset or blackout or skip step (——) for step 3	Red - CW / User 1 - 4 / Blackout / ——
4.Step	Select colour preset or blackout or skip step (——) for step 4	Red - CW / User 1 - 4 / Blackout / ——

SLAVE MODE

Standard slave operation: Starting from the main display, press MENU to enter the main menu. Using the ▲ or ▼ buttons, now select the menu item **Slave**, confirm with ENTER, then select slave group 0, and confirm again. Connect the slave and the master units (same model, same software version) using a DMX cable and activate one of the stand-alone operating modes on the master unit. The slave unit will now follow the master unit.

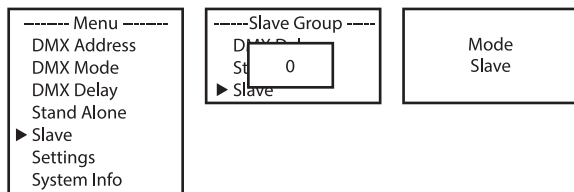

Extended slave mode: If you want to control the slave units in master/slave mode using one of the stand-alone operating modes **Auto**, **Pattern**, or **Loop**, the control signal can be played back with a time delay of up to fifteen steps. The delay time is set in the menu of the master unit's corresponding stand-alone operating mode; the delay factor in the slave menu of the corresponding fixture (slave group). This is a simple way to create a running light effect with a large number of identical lights that are running the same software version, which would otherwise require a suitable DMX controller and extensive programming. Connect the slave and master units (same model, same software version) using a DMX cable.

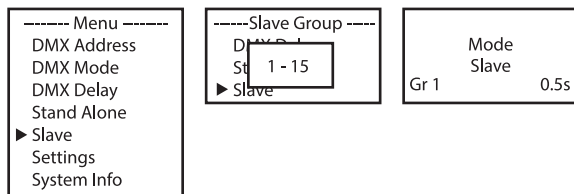

Assign the lights to one of up to 15 groups (plus Group 0) according to preference, whereby several lights can be assigned to one group. The group number is also the factor by which the delay time set in the master unit is multiplied.

Set-up example:

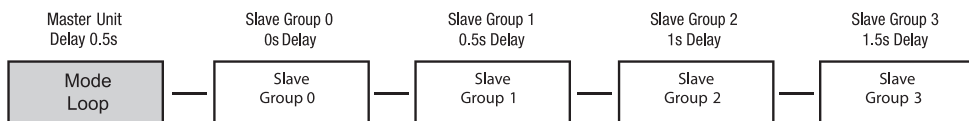

SYSTEM SETTINGS (Settings)

Starting from the main display, press MENU to enter the main menu. Using the ▲ or ▼ buttons, now select the menu item **Settings** and confirm with ENTER.

----- Menu -----	----- Settings -----
DMX Address	► Disp Rev No/Yes
DMX Mode	Disp Back On/Off
DMX Delay	
Stand Alone	Edit Preset A-C
Slave	Service PW
► Settings	
System Info	

This takes you to the sub-menu for setting the sub-menu items (see table, select with ▲ or ▼, confirm with ENTER, change value or status with ▲ or ▼, and confirm with ENTER).

Settings			
Disp Rev	Display rotation	No	No display rotation
		Yes	Display is rotated by 180° (for example, for overhead installation)
Disp Back	Display lighting	Off	Deactivation of the display lighting after approximately 30 seconds of inactivity
		On	Display lighting permanently on
Sig Fail	Operational status on control signal interruption	Hold	Last command is retained
		Black	Instant blackout
		User 1	User Colour 1 is activated
Mirror	Mirror LED segments	Off	Function disabled
		On	LED segments are mirrored
Power Mode	Battery life and brightness setting	Full	Maximum brightness with reduced battery life
		STD	Medium brightness with medium battery life
		ECO	Reduced brightness with long battery life
IR Remote	Control via IR remote control	Off	Control via IR remote control deactivated
		On	Control via IR remote control activated
Sound	Control via sound	Load	The last value is retained until the next impulse
		Off	Pulse activates LEDs; blacks out after a short time until the next pulse

PWM	LED PWM frequency	650 Hz	Selection of the LED PWM frequency
		1530 Hz	
		2150 Hz	
		4000 Hz	
Calibration	Colour calibration	Red	Individual colour calibration. Cross-mode brightness setting with values from 0–255
		Green	
		Blue	
		White	
Reset	Reset the device	Factory	Reset to factory settings
		Preset A	Reset to Preset A
		Preset B	Reset to Preset B
		Preset C	Reset to Preset C
Edit Preset	Store all system settings in three custom presets	Preset A	Store with ENTER
		Preset B	Store with ENTER
		Preset C	Store with ENTER
Service	For service purposes only	Password	

BATTERY LIFE

Power Mode	RGBW
Full (100% = ca. 2300 lm)	Approximately 3 h
STD (70% = ca. 1600 lm)	Approximately 4.5 h
ECO (55% = ca. 1300 lm)	Approximately 5.5 h

SYSTEM INFORMATION (System Info)

Starting from the main display, press MENU to enter the main menu. Using the ▲ or ▼ buttons, now select the menu item **System Info** and confirm with ENTER.

----- Menu -----	----- System Info -----
DMX Address	► Firmware
DMX Mode	Temperature
DMX Delay	Op Hours
Stand Alone	
Slave	
Settings	
► System Info	

This takes you to the sub-menu to set sub-menu items (see table, select with ▲ or ▼, confirm with ENTER, change value or status with ▲ or ▼, and confirm with ENTER).

System info			
Firmware	Device's firmware version	Vx.xx	
Temperature	Temperature of the LED unit in degrees Celsius or degrees Fahrenheit	LED	xx°C/°F
		Unit	°C
			°F
Op Hours	Displays operating time in hours and minutes	xx:xxh	

IR REMOTE CONTROL

(optionally available; product number CLPFLAT1REMOTE)



Aim the infrared remote control directly at the infrared sensor on the front of the light. The maximum range is approximately 8 metres. In DMX and slave operating modes, the fixture's IR sensor is deactivated. The infrared remote control directly controls the internal stand-alone operating modes. Activate operation via IR remote control in the system settings (Settings -> IR Remote -> On) and start one of the stand-alone operating modes.

BL / ON/OFF (Blackout)

Press the BL button to switch off all LEDs (blackout), regardless of the operating mode enabled via remote control. Press the BL button again to reactivate the previously selected operating mode.

SP (Speed)

11-stage speed setting for the lighting sequence in stand-alone operating mode Auto (Au). Level 1 creates the fastest lighting sequence. Press the button again to activate level 2 for a slower colour-change sequence, and repeat for levels 3, 4, 5, etc., whereby level 11 provides the slowest lighting sequence speed.

(Brightness)

Sets the overall brightness in six levels. The different brightness levels can be accessed by repeatedly pressing this button (level 1 = blackout).

FL (Flash/Stroboscope)

Six-level speed setting for the strobe effect. Level 1 deactivates the strobe effect, level 2 produces a slow flash frequency, followed by levels 3 to 5. Level 6 generates the fastest flash frequency. The strobe effect can only be used in the colour blending mode RGBW.

R, G, B, and W (A, UV, CW, and WW without function)

These four buttons can be used to create individual colours by mixing R, G, B, and W. The six brightness levels can be accessed by repeatedly pressing the respective colour button, whereby the LEDs are switched off at Level 1.

Ju (colour change)

Colour changes jump (colour jumping) The speed at which the colours change is set with the SP (Speed) button.

Fa (colour fade)

Colours fade into each other (colour fading). The speed at which the colours change is set with the SP (Speed) button.

Au (Auto operating mode)

Press the Au button to start the Auto stand-alone operating mode. Use the Speed button to control the speed of the lighting sequence.

Su (music-controlled lighting sequence)

Six different sound presets can be accessed by repeatedly pressing the SU button (sound 1 to 6). The pre-selected color presets change with the bass pulses. The microphone used for this is found on the back of the fixture.

CM Press CM+ or CM- to start the Color Presets stand-alone operating mode. The various color presets are accessed by repeatedly pressing one of the two buttons.

Pr+ / Pr- (without function)

SET-UP AND INSTALLATION



DANGER: Installation, especially overhead installation, requires extensive experience, relevant and up-to-date expertise and competence, including the calculation of working load limits, of the installation material used, and regular safety checks of all installation materials and fixtures! If you do not have these qualifications, do not attempt to carry out an installation yourself, but use the help of appropriately qualified specialist companies! There is a risk that devices that are incorrectly mounted and secured may come loose and fall down. This can cause serious injury or death.

Integrated support feet

Thanks to the integrated support feet, which can be folded without tools, the fixture can be positioned in a suitable place on a flat surface at different installation angles.



0°: Lay the fixture flat on a surface.

15°: Fold out the centrally mounted foot and position the fixture on it.

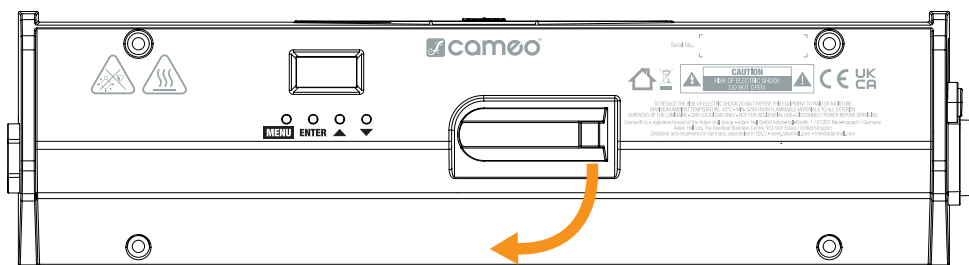

30°: Place the fixture on the angled side.

60°: Fold out both side-mounted feet and position the fixture on them (press the spring-loaded locking button and the foot will fold out automatically and the locking button will engage again).

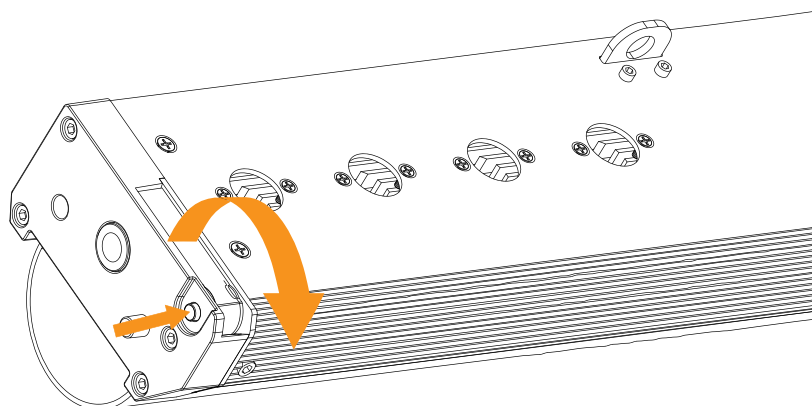

90°: Fold out the centrally mounted foot and place the fixture on the back.

Connecting ROOTBARs with each other

The side sections are designed so that they interlock when two fixtures are connected. Strong magnets make it easier to connect them and ensure a tight connection. For truss mounting, each light must be mounted with two suitable truss clamps and secured with a suitable safety cable.

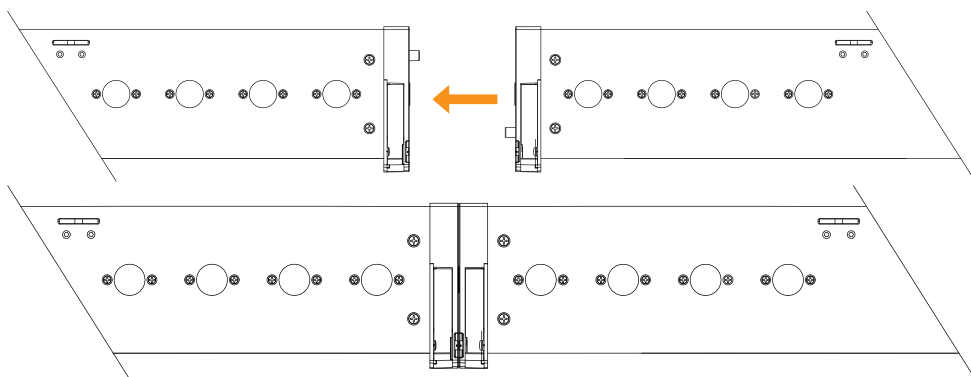

An additional Omega bracket can be used for a stable mechanical connection (two pieces included in the packaging content).

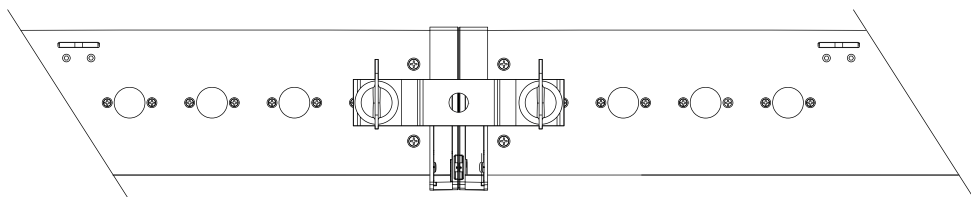

M10 thread

The side sections are outfitted with an M10 thread for attaching a clamp, allowing for vertical suspension on a truss (maximum one ROOTBAR, suitable clamp with M10 bolt, product no. SCP710B-SET1, secure the fixture to the upper securing eyelet).

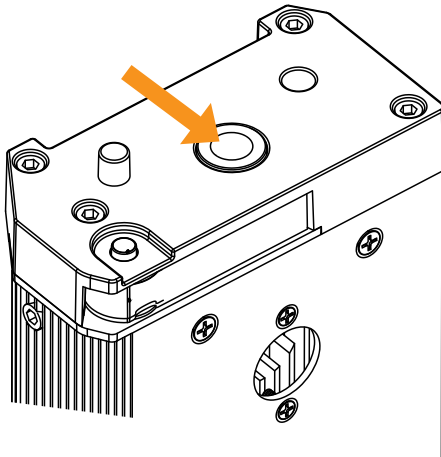

Assembling the feet

To use the two infinitely adjustable feet, screw one foot to each Omega bracket using an M10 Allen screw and an M10 lock nut. Then fit the Omega brackets to the fixture. The wing screws for adjusting the beam direction are located on the sides of the feet.

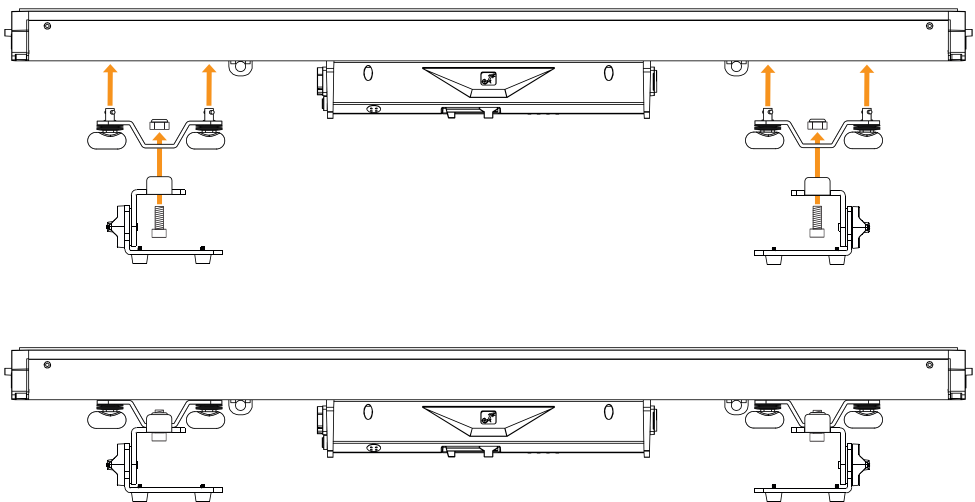

Truss installation

Truss installation can be carried out using two Omega brackets and two feet, which are attached to the back of the fixture (1, two positions per side are possible). Two Omega brackets and two bases are included in the package contents. Suitable beam clamps are available as an option. The truss clamps are attached to the feet. Ensure firm connections and secure the fixture to one of the securing lugs (2) with a suitable safety cable.

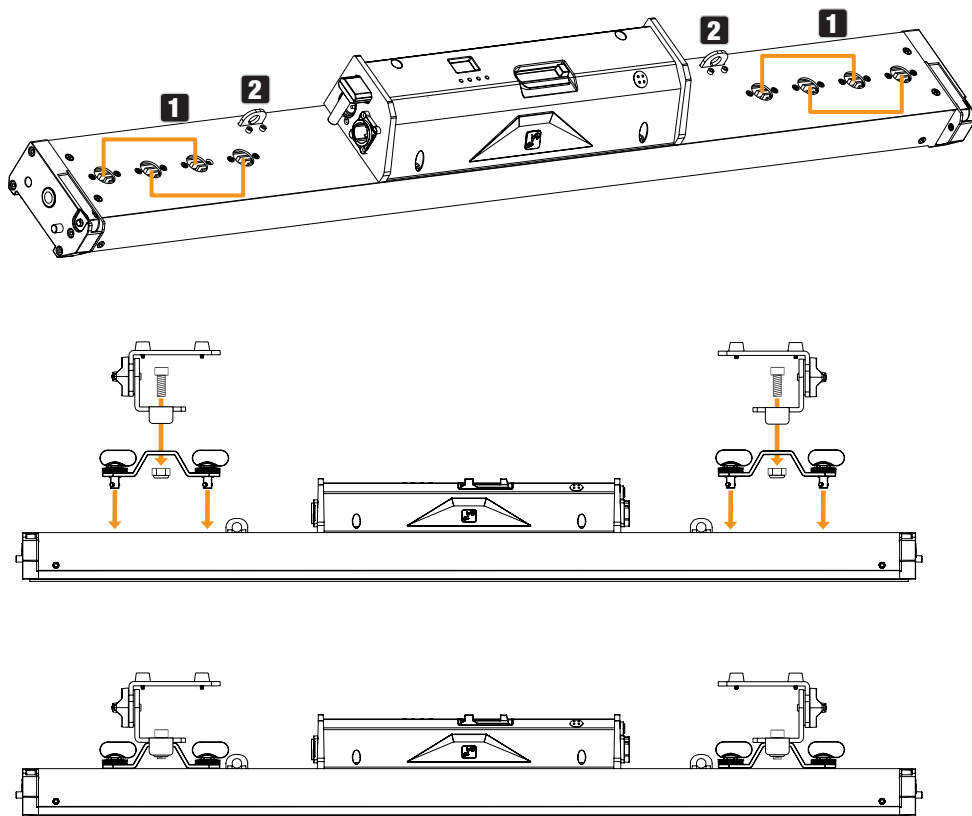

Clustering fixtures

The fixtures may only be connected directly to each other using Omega brackets in the following mounting options (maximum two fixtures, two Omega brackets per fixture included in the packaging content). Truss installation must be carried out with separate Omega brackets plus truss clamps; it must not be carried out on Omega brackets as a connecting link between two fixtures. Every fixture must be secured to the truss with a suitable safety rope!

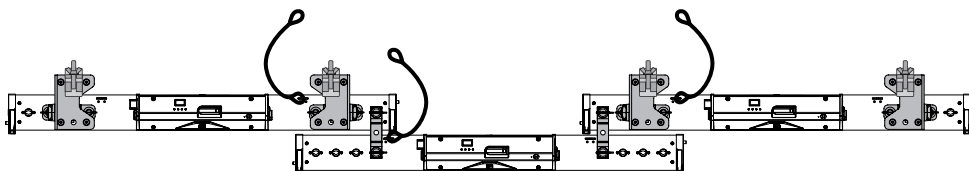
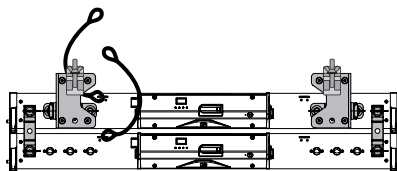

INSTALLING THE FROST FILTER

A frost filter is included in the packaging content of the ROOTBAR. To attach the frost filter to the fixture, first loosen the three knurled screws on the front of the fixture, screw them out of the threads as far as possible, and place the frost filter on the fixture (place the large openings of the keyholes in the frost filter over the screw heads, see Fig. 1). Then slide the frost filter to the side as far as it will go (Fig. 2). Now re-tighten the three knurled screws (Fig. 3).

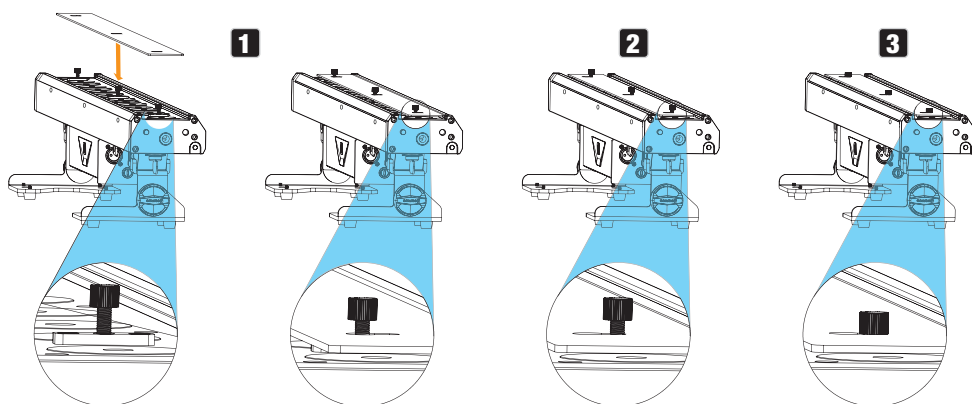

MOUNTING THE GLARE SHIELD

A glare shield is included in the packaging content of the ROOTBAR. There are three threads (1) on the top edge of one side of the ROOTBAR housing. Use the three knurled screws on the glare shield (2) to attach it to the ROOTBAR's housing.

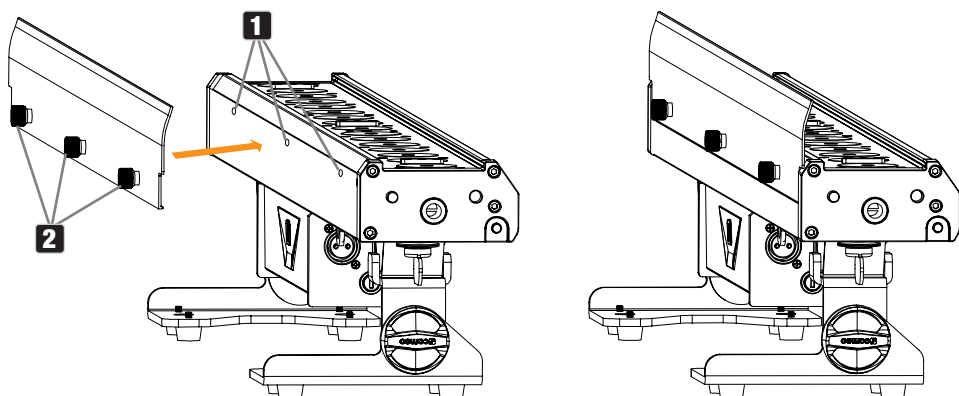

MOUNTING THE NEON TUBE FILTER

A neon tube filter for a neon tube effect is included in the packaging content of the ROOTBAR. The neon tube filter is equipped with angled edges on both long sides which ensure a secure hold in the grooves provided on the inside of the fixture front. Neon tube filters and frost filters can be installed and used together.

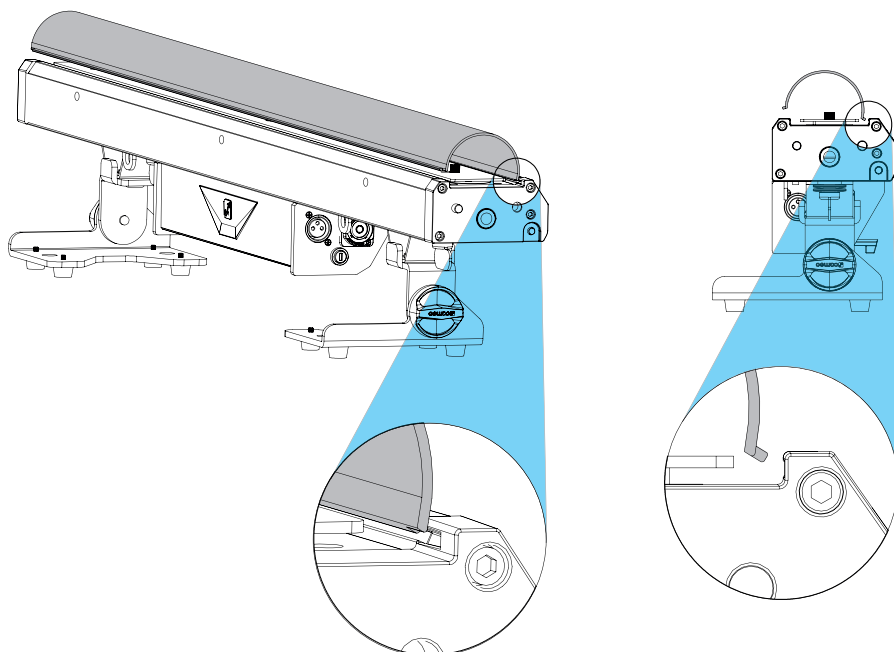

1. Insert an angled edge into a groove.
2. Now compress the neon tube filter slightly by pressing on the opposite side of the neon tube filter.
3. Lower this side to the front of the fixture.
4. Now release the pressure from the neon tube filter so that the second edge slides into the second groove in the front of the fixture.

Make sure that the edges of the neon tube filter are correctly positioned in the grooves so that the neon tube filter cannot fall out even when installed overhead!

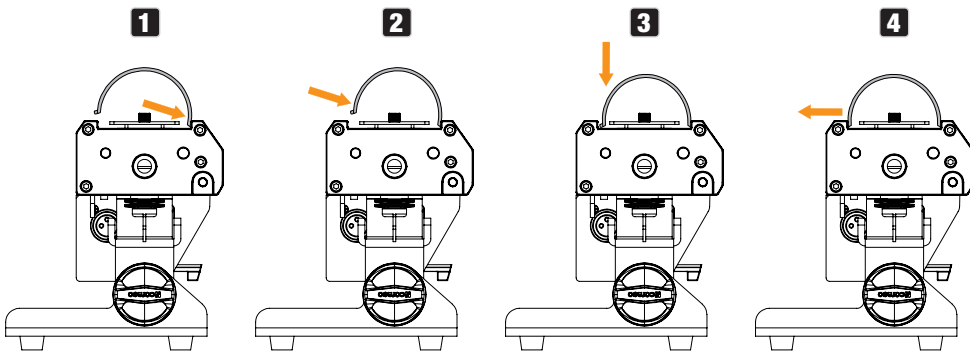

CARE, MAINTENANCE, AND REPAIR

In order to ensure the long-term, proper functioning of the device, it must be regularly cleaned and, if necessary, serviced. The servicing requirement depends on the intensity of use and the environment in which it is used.

A visual inspection should be carried out before each commissioning. In particular, all safety-relevant components, such as connecting elements, safety points, electrical connections and cables, must be taken into account. Furthermore, we recommend carrying out all the applicable maintenance measures specified below once every 500 operating hours or, in the case of a lower intensity of use, at the latest after one year. Warranty claims may be limited should defects result from inadequate service and maintenance.

CARE (can be performed by the user)



WARNING! Before carrying out any care or maintenance, the power supply – and, if possible, all device connections – must be disconnected.



PLEASE NOTE! Improper care can lead to impairment or even destruction of the device.

1. Housing surfaces must be cleaned with a clean, damp cloth. Make sure that no moisture can penetrate the device.

2. Air inlets and outlets must be regularly cleaned of dust and dirt. If compressed air is used, make sure that damage to the device is prevented (for example, fans must be blocked in this case).
3. Cables and connectors must be cleaned regularly, and dust and dirt must be removed.
4. In general, no cleaning agents or abrasive agents may be used; otherwise, the surface finish may be damaged.
5. Devices must be stored in a dry environment and protected from dust and dirt.

MAINTENANCE AND REPAIR (qualified personnel only)



DANGER! There are live components in the device. Even after disconnecting from the mains, there may still be residual voltage in the device, for example, due to charged capacitors.



PLEASE NOTE! There are no user-serviceable assemblies in the device.



PLEASE NOTE! Maintenance and repair work may only be carried out by qualified specialist personnel authorised by the manufacturer. If in doubt, consult the manufacturer.



PLEASE NOTE! Improperly performed maintenance work may affect warranty claims.

OPTIONAL ACCESSORIES

CLIDMXSTICKG2

Wireless DMX receiver

CLPFLAT1REMOTE

Infrared remote control

SCP710BSET1

Truss clamp with M10 bolt

TECHNICAL DATA

ENGLISH

Item number	CLROOTBARBAT
Product category	Static battery powered LED light

DEUTSCH

Type	LED bar
Light source	4 W RGBW LED
LED quantity	12 pcs
Luminous flux	2300 lm
Lense / optic	plastic lense
LED PWM	650 Hz; 1530 Hz; 2150 Hz; 4000 Hz

FRANÇAIS

Dimmer resolution	8 / 16 bit
Dimmer curves	Linear, exponential, s-curve, logarithmic
Strobe	0 Hz - 20 Hz
Calibration	User

ESPAÑOL

CRI	70 @ 6000 K
Beam angle / field angle	20° / 37°
Color mixing	RGBW
Control protocols	DMX; stand alone; Master/Slave; iDMX Stick
Data connections	3-Pin XLR in/out, iDMX Stick
DMX modes	2CH, 4CH-sound, 4CH-direct, 5CH, 6CH-pattern, 6CH-direct, 9CH- 1, 9CH-pattern, 16CH, 19CH, D3CH, D5CH-1, D5CH-2, D6CH, D7CH, D10CH

POLSKI

DMX functions	RGBW static; chase, color presets, pattern, sound, DMX delay(EZ-Chase)
Stand alone	RGBW static, auto, color presets, pattern, user color, loop, master/slave, IR control

ITALIANO

System settings	Display reverse, display backlight, signal fail, sound, PWM, calibration, IR-remote, reset (factory, preset A-C), edit preset (A-C), service, power modes
User interface	2 row O-LED display with 4 buttons

DMX

IP rating	IP20
Ambient temperature rating	0°C - 40°C
Max battery charging ambient temperature	35°C
Humidity rating	Up to 80 % (non condensing)
Cooling system	Passive convection

Noise level	Noise free (fanless)
Operation voltage	AC 100 V - 240 V; 50 / 60 Hz
Max. power consumption	62 W
Fuse	F3 A / 250 V
Power connection	Seetronic TR1 In + Out
Max. load of outlet	14 A
Risk group	<4m RG2, >4m RG1
Battery	Li-ion battery
Battery nominal voltage	14.4 V
Battery capacity	6.4 Ah (92.16 Wh)
Minimum distance to the illuminated surface	0.1 m
Minimum distance to normally flammable materials	0.1 m
Housing	String cast aluminium, black powder coated. ABS backpack
Dimensions	1042 mm x 106 mm x 116 mm (without accessories)
Weight	5 kg (without accessories)
Accessories included	Glare shield, filter, neon tube filter, 2x omega bracket, power cable, 2x adjustable feet
Accessories optional	SCP710BSET1, CLPFLAT1REMOTE, CLIDMXSTICKG2

MINIMUM DISTANCE TO ILLUMINATED SURFACE

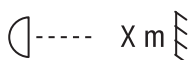

This symbol with the distance stated in metres (m) indicates the minimum distance of the light fixture to the illuminated surface. The value valid for this device can be found in the technical data in this manual and is printed on the device!

MINIMUM DISTANCE TO NORMALLY FLAMMABLE MATERIALS



This symbol with the distance stated in metres (m) indicates the minimum distance of the device to normally flammable materials. The value valid for this device can be found in the technical data in this manual!

DISPOSAL



PACKAGING:

1. Packaging can be recycled using the usual disposal methods.
2. Please separate the packaging in accordance with the disposal laws and recycling regulations in your country.



DEVICE:

1. This device is subject to the European Directive on Waste Electrical and Electronic Equipment, as amended. WEEE Directive Waste Electrical and Electronic Equipment. Waste equipment does not belong in household waste. Waste equipment must be disposed of via an authorised waste disposal company or a municipal waste disposal facility. Please observe the applicable regulations in your country!
2. Observe all disposal laws and regulations applicable in your country.
3. As a private customer, you can obtain information on environmentally-friendly disposal options from the seller of the product or the appropriate regional authorities.

MANUFACTURER'S DECLARATIONS

Manufacturer's warranty and limitation of liability

Adam Hall GmbH | Adam-Hall-Str.1 | 61267 Neu-Anspach | Germany

Email: Info@adamhall.com / +49 (0)6081 / 9419-0

Our current warranty conditions and limitation of liability can be found at:

https://cdn-shop.adamhall.com/media/pdf/Manufacturers-Declarations-CAMEO_DE_EN_ES_FR.pdf

For service requests, please contact your distribution partner.

EC conformity

Adam Hall GmbH hereby confirms that this product meets the following guidelines

(if applicable):

Low-Voltage Directive (2014/35/EU)

EMC Directive (2014/30/EU)

RoHS Directive

Radio Equipment Directive

EC Declaration of Conformity

Declarations of conformity for the products subject to the Low-Voltage Directive, the EMC Directive, and the RoHS Directive can be requested at: info@adamhall.com.

Declarations of conformity for products subject to RED can be downloaded from www.adamhall.com/compliance/.

Subject to misprints and errors, as well as technical or other modifications!

DMX CONTROL / DMX STEUERUNG / PILOTAGE DMX / CONTROL DMX / STEROWANIE DMX / CONTROLLO DMX

2CH	4CH-Sound					
Channel	Channel	Function	Values			
1	1	Dimmer	000	-	255	0% to 100%
	2	Strobe Functions	000	-	005	Open
			006	-	010	Closed
			011	-	022	Ramp up/down slow to fast
			023	-	033	Ramp up/down random slow to fast
			034	-	045	Ramp up slow to fast
			046	-	056	Ramp up random slow to fast
			057	-	068	Ramp down slow to fast
			069	-	079	Ramp down random slow to fast
			080	-	102	Random Strobe effect slow to fast
			103	-	127	Strobe Break effect 5s to 1s (short burst with break)
			128	-	250	Strobe slow to fast (<1Hz to 20Hz)
			251	-	255	Open
2	3	Color Presets	000	-	005	No function
			006	-	013	Red
			014	-	021	Amber
			022	-	029	Yellow warm
			030	-	037	Yellow
			038	-	045	Green
			046	-	053	Turquoise
			054	-	061	Cyan
			062	-	069	Blue
			070	-	077	Lavender
			078	-	085	Mauve
			086	-	093	Magenta
			094	-	101	Pink
			102	-	109	Warm White

			110	-	117	White
			118	-	125	Cold White
			126	-	127	Color Jumping/Fading Stop
			128	-	164	Color Jumping slow to fast
			165	-	201	Color Fading slow to fast
			202	-	207	User Color 1
			208	-	213	User Color 2
			214	-	219	User Color 3
			220	-	225	User Color 4
			226	-	255	No function
	4	Sound (Triggers Strobe, Color Jumping & Fading)	000	-	255	No function
			006	-	255	Sound Control On, mic sensitivity low to high

4CH-Direct					
Channel	Function	Values			
1	Red	000	-	255	0% to 100%
2	Green	000	-	255	0% to 100%
3	Blue	000	-	255	0% to 100%
4	White	000	-	255	0% to 100%

		5CH				
		Channel	Function	Values		
ENGLISH	1	Dimmer	000	-	255	0% to 100%
	2	Strobe	000	-	005	Open
006			-	255	Strobe slow to fast (<1Hz to 20Hz)	
DEUTSCH	3	Chase	000	-	005	No function
			006	-	026	Jump 10s to 4s
			027	-	127	Jump 4s to 0.1s
			128	-	148	Fade 10s to 4s
			149	-	255	Fade 4s to 0.1s
FRANCAIS	4	Color Presets 1	000	-	005	No function
			006	-	013	Red
			014	-	021	Amber
			022	-	029	Yellow warm
			030	-	037	Yellow
			038	-	045	Green
			046	-	053	Turquoise
			054	-	061	Cyan
			062	-	069	Blue
			070	-	077	Lavender
			078	-	085	Mauve
			086	-	093	Magenta
			094	-	101	Pink
			102	-	109	Warm White
			110	-	117	White
			118	-	125	Cold White
			126	-	127	Color Jumping/Fading Stop
			128	-	164	Color Jumping slow to fast
			165	-	201	Color Fading slow to fast
			POLSKI			202
208	-	213				User Color 2
214	-	219				User Color 3
220	-	225				User Color 4
ITALIANO			226	-	255	No function
DMX						

5	Color Presets 2	000	-	005	No function
		006	-	013	Red
		014	-	021	Amber
		022	-	029	Yellow warm
		030	-	037	Yellow
		038	-	045	Green
		046	-	053	Turquoise
		054	-	061	Cyan
		062	-	069	Blue
		070	-	077	Lavender
		078	-	085	Mauve
		086	-	093	Magenta
		094	-	101	Pink
		102	-	109	Warm White
		110	-	117	White
		118	-	125	Cold White
		126	-	127	Color Jumping/Fading Stop
		128	-	164	Color Jumping slow to fast
		165	-	201	Color Fading slow to fast
		202	-	207	User Color 1
		208	-	213	User Color 2
		214	-	219	User Color 3
		220	-	225	User Color 4
		226	-	255	No function

**6CH-Pat-
tern**

Channel	Function	Values			
1	Dimmer	000	-	255	0% to 100%
2	Strobe Functions	000	-	005	Open
		006	-	010	Closed
		011	-	022	Ramp up/down slow to fast
		023	-	033	Ramp up/down random slow to fast
		034	-	045	Ramp up slow to fast
		046	-	056	Ramp up random slow to fast
		057	-	068	Ramp down slow to fast
		069	-	079	Ramp down random slow to fast
		080	-	102	Random Strobe effect slow to fast
		103	-	127	Strobe Break effect 5s to 1s (short burst with break)
		128	-	250	Strobe slow to fast (<1Hz to 20Hz)
		251	-	255	Open
3	Color Presets	000	-	005	No function
		006	-	013	Red
		014	-	021	Amber
		022	-	029	Yellow warm
		030	-	037	Yellow
		038	-	045	Green
		046	-	053	Turquoise
		054	-	061	Cyan
		062	-	069	Blue
		070	-	077	Lavender
		078	-	085	Mauve
		086	-	093	Magenta
		094	-	101	Pink
		102	-	109	Warm White
		110	-	117	White
		118	-	125	Cold White

		126	-	127	Color Jumping/Fading Stop
		128	-	164	Color Jumping slow to fast
		165	-	201	Color Fading slow to fast
		202	-	207	User Color 1
		208	-	213	User Color 2
		214	-	219	User Color 3
		220	-	225	User Color 4
		226	-	255	No function
4	Pattern Selection	000	-	005	Off
		006	-	026	1
		027	-	047	2
		048	-	068	3
		069	-	089	4
		090	-	110	5
		111	-	131	6
		132	-	152	7
		153	-	173	8
		174	-	194	9
		195	-	215	10
		216	-	236	11
		237	-	255	12
5	Pattern Position & Speed	000	-	005	Pattern Speed Stop
		006	-	063	Pattern Speed slow to fast (Chase)
		064	-	127	Pattern Speed fast to slow (Chase) (backwards)
		128	-	127	Pattern Speed slow to fast (Fade)
		192	-	255	Pattern Speed fast to slow (Fade) (backwards)
6	Sound (Triggers Strobe, Color Jumping & Fading, Patterns)	000	-	255	No function
		006	-	255	Sound Control On, mic sensitivity low to high

	16CH	19CH				
	Channel	Channel	Function	Values		
ENGLISH		1	Dimmer	000	-	255
		2	Dimmer fine	000	-	255
DEUTSCH		3	Strobe Functions	000	-	005
						010
				011	-	022
				023	-	033
				034	-	045
				046	-	056
				057	-	068
				069	-	079
				080	-	102
				103	-	127
				128	-	250
				251	-	255
FRANCAIS	1	4	Red 1	000	-	255
	2	5	Green 1	000	-	255
	3	6	Blue 1	000	-	255
	4	7	White 1	000	-	255
	5	8	Red 2	000	-	255
	6	9	Green 2	000	-	255
	7	10	Blue 2	000	-	255
	8	11	White 2	000	-	255
	9	12	Red 3	000	-	255
	10	13	Green 3	000	-	255
	11	14	Blue 3	000	-	255
	12	15	White 3	000	-	255
	13	16	Red 4	000	-	255
	14	17	Green 4	000	-	255
	15	18	Blue 4	000	-	255
	16	19	White 4	000	-	255

6CH-Direct	9CH-1	9CH-Pattern				
Channel	Channel	Channel	Function	Values		
1	1	1	Dimmer	000	-	255
	2		Dimmer fine	000	-	255
2			Strobe	000	-	005
				006	-	255
	3	2	Strobe Functions	000	-	005
				006	-	010
				011	-	022
				023	-	033
				034	-	045
				046	-	056
				057	-	068
				069	-	079
				080	-	102
				103	-	127
				128	-	250
				251	-	255
3	4	3	Red	000	-	255
4	5	4	Green	000	-	255
5	6	5	Blue	000	-	255
6	7	6	White	000	-	255

8	Color Presets (override Color Mixing)	000	-	005	No function
		006	-	013	Red
		014	-	021	Amber
		022	-	029	Yellow warm
		030	-	037	Yellow
		038	-	045	Green
		046	-	053	Turquoise
		054	-	061	Cyan
		062	-	069	Blue
		070	-	077	Lavender
		078	-	085	Mauve
		086	-	093	Magenta
		094	-	101	Pink
		102	-	109	Warm White
		110	-	117	White
		118	-	125	Cold White
		126	-	127	Color Jumping/Fading Stop
		128	-	164	Color Jumping slow to fast
		165	-	201	Color Fading slow to fast
		202	-	207	User Color 1
		208	-	213	User Color 2
		214	-	219	User Color 3
		220	-	225	User Color 4
		226	-	255	No function

		7	Pattern Selection	000	-	005	Off
				006	-	026	1
				027	-	047	2
				048	-	068	3
				069	-	089	4
				090	-	110	5
				111	-	131	6
				132	-	152	7
				153	-	173	8
				174	-	194	9
				195	-	215	10
				216	-	236	11
				237	-	255	12
		8	Pattern Position & Speed	000	-	005	Pattern Speed Stop
				006	-	063	Pattern Speed slow to fast (Chase)
				064	-	127	Pattern Speed fast to slow (Chase) (backwards)
				128	-	127	Pattern Speed slow to fast (Fade)
				192	-	255	Pattern Speed fast to slow (Fade) (backwards)
	9	9	Sound (Triggers Strobe, Color Jumping & Fading, Patterns)	000	-	255	No function
				006	-	255	Sound Control On, mic sensitivity low to high

		D6CH				
		Channel	Function	Values		
ENGLISH	1	Dimmer	000	-	255	0% to 100%
	2	Strobe	000	-	005	Open
006			-	255	Strobe slow to fast (<1Hz to 20Hz)	
DEUTSCH	3	Chase	000	-	005	No function
			006	-	026	Jump 10s to 4s
			027	-	127	Jump 4s to 0.1s
			128	-	148	Fade 10s to 4s
			149	-	255	Fade 4s to 0.1s
FRANCAIS	4	Color Presets 1	000	-	005	No function
			006	-	013	Red
			014	-	021	Amber
			022	-	029	Yellow warm
			030	-	037	Yellow
			038	-	045	Green
			046	-	053	Turquoise
			054	-	061	Cyan
			062	-	069	Blue
			070	-	077	Lavender
			078	-	085	Mauve
			086	-	093	Magenta
			094	-	101	Pink
			102	-	109	Warm White
			110	-	117	White
			118	-	125	Cold White
			126	-	127	Color Jumping/Fading Stop
			128	-	164	Color Jumping slow to fast
			165	-	201	Color Fading slow to fast
			202	-	207	User Color 1
			208	-	213	User Color 2
			214	-	219	User Color 3
			220	-	225	User Color 4
			226	-	255	No function

5	Color Presets 2	000	-	005	No function
		006	-	013	Red
		014	-	021	Amber
		022	-	029	Yellow warm
		030	-	037	Yellow
		038	-	045	Green
		046	-	053	Turquoise
		054	-	061	Cyan
		062	-	069	Blue
		070	-	077	Lavender
		078	-	085	Mauve
		086	-	093	Magenta
		094	-	101	Pink
		102	-	109	Warm White
		110	-	117	White
		118	-	125	Cold White
		126	-	127	Color Jumping/Fading Stop
		128	-	164	Color Jumping slow to fast
		165	-	201	Color Fading slow to fast
		202	-	207	User Color 1
		208	-	213	User Color 2
		214	-	219	User Color 3
		220	-	225	User Color 4
		226	-	255	No function
6	DMX Delay	000	-	005	Off (no Delay)
		006	-	255	0,1s to 2,0s

D5CH-2					
Channel	Function	Values			
1	Red	000	-	255	0% to 100%
2	Green	000	-	255	0% to 100%
3	Blue	000	-	255	0% to 100%
4	White	000	-	255	0% to 100%
5	DMX Delay	000	-	005	Off (no Delay)
		006	-	255	0,1s to 2,0s

D7CH	D10CH					
Channel	Channel	Function	Values			
1	1	Dimmer	000	-	255	0% to 100%
	2	Dimmer fine	000	-	255	
2		Strobe	000	-	005	Open
			006	-	255	Strobe slow to fast (<1Hz to 20Hz)
	3	Strobe Functions	000	-	005	Open
			006	-	010	Closed
			011	-	022	Ramp up/down slow to fast
			023	-	033	Ramp up/down random slow to fast
			034	-	045	Ramp up slow to fast
			046	-	056	Ramp up random slow to fast
			057	-	068	Ramp down slow to fast
			069	-	079	Ramp down random slow to fast
			080	-	102	Random Strobe effect slow to fast
			103	-	127	Strobe Break effect 5s to 1s (short burst with break)
			128	-	250	Strobe slow to fast (<1Hz to 20Hz)
			251	-	255	Open
3	4	Red	000	-	255	0% to 100%
4	5	Green	000	-	255	0% to 100%
5	6	Blue	000	-	255	0% to 100%
6	7	White	000	-	255	0% to 100%

	8	Color Presets (override Color Mixing)	000	-	005	No function
			006	-	013	Red
			014	-	021	Amber
			022	-	029	Yellow warm
			030	-	037	Yellow
			038	-	045	Green
			046	-	053	Turquoise
			054	-	061	Cyan
			062	-	069	Blue
			070	-	077	Lavender
			078	-	085	Mauve
			086	-	093	Magenta
			094	-	101	Pink
			102	-	109	Warm White
			110	-	117	White
			118	-	125	Cold White
			126	-	127	Color Jumping/Fading Stop
			128	-	164	Color Jumping slow to fast
			165	-	201	Color Fading slow to fast
			202	-	207	User Color 1
	9	Sound (Triggers Strobe, Color Jumping & Fading)	000	-	255	No function
			006	-	255	Sound Control On, mic sensitivity low to high
7	10	DMX Delay	000	-	005	Off (no Delay)
			006	-	255	0,1s to 2,0s

ENGLISH

DEUTSCH

FRANCAIS

ESPAÑOL

POLSKI

ITALIANO

DMX

D3CH	D5CH-1					
Channel	Channel	Function	Values			
1	1	Dimmer	000	-	255	0% to 100%
	2	Strobe Functions	000	-	005	Open
			006	-	010	Closed
			011	-	022	Ramp up/down slow to fast
			023	-	033	Ramp up/down random slow to fast
			034	-	045	Ramp up slow to fast
			046	-	056	Ramp up random slow to fast
			057	-	068	Ramp down slow to fast
			069	-	079	Ramp down random slow to fast
			080	-	102	Random Strobe effect slow to fast
			103	-	127	Strobe Break effect 5s to 1s (short burst with break)
			128	-	250	Strobe slow to fast (<1Hz to 20Hz)
			251	-	255	Open

2	3	Color Presets	000	-	005	No function
			006	-	013	Red
			014	-	021	Amber
			022	-	029	Yellow warm
			030	-	037	Yellow
			038	-	045	Green
			046	-	053	Turquoise
			054	-	061	Cyan
			062	-	069	Blue
			070	-	077	Lavender
			078	-	085	Mauve
			086	-	093	Magenta
			094	-	101	Pink
			102	-	109	Warm White
			110	-	117	White
			118	-	125	Cold White
			126	-	127	Color Jumping/Fading Stop
			128	-	164	Color Jumping slow to fast
			165	-	201	Color Fading slow to fast
			202	-	207	User Color 1
			208	-	213	User Color 2
			214	-	219	User Color 3
			220	-	225	User Color 4
			226	-	255	No function
	4	Sound (Triggers Strobe, Color Jumping & Fading)	000	-	255	No function
			006	-	255	Sound Control On, mic sensitivity low to high
3	5	DMX Delay	000	-	005	Off (no Delay)
			006	-	255	0,1s to 2,0s

Adam Hall GmbH

Adam-Hall-Str. 1 | 61267 Neu-Anspach | Germany

Phone: +49 6081 9419-0 | adamhall.com

Adam Hall Ltd. | The Seedbed Business Centre | SS3 9QY Essex | United Kingdom



REV: 01